

GIRO | Order Specification Guide



1. Specify Light Module

Product	LED/K Color	Length	Optic	End Configuration	Options
GIL = GIRO Light Module	HW = 3000K MW = 3500K MN = 4000K CN = 5000K For tunable white, consult factory.	_____ FT _____ IN = Linear Run (Feet and Inches) Light module individual lengths will be determined by factory and indicated in shop drawings, refer to example layouts on page 5 for more information.	AM = Ambient CG = Cove Glow GZ = Graze	SS = 2 Straight Ends SI = Straight End & Internal Corner SE = Straight End & External Corner II = 2 Internal Corners EE = 2 External Corners IE = Internal & External Corner Refer to End Configuration Examples on page 5 for more information.	IP = IP65 CP = Chicago Plenum

2. Specify Housing

Product	Length	Mounting	Color
GIH = GIRO Housing	_____ FT _____ IN = Linear Run (Feet and Inches) Enter same linear run length as above light module run length. Housings will be provided as a combination of 4ft and 8ft segments as indicated on factory provided shop drawings.	G = Grid FL = Flange Trim Gypsum	W = White B = Black C = Custom
www.jlc-tech.com/patents Power supply ordered separately. Example Specification Code: GIL-MW-8FT6IN-GZ-SS + GIH-8FT6IN-G-W			

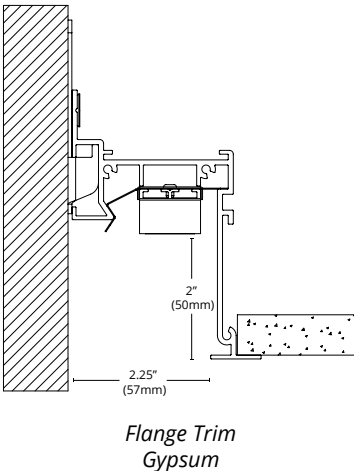
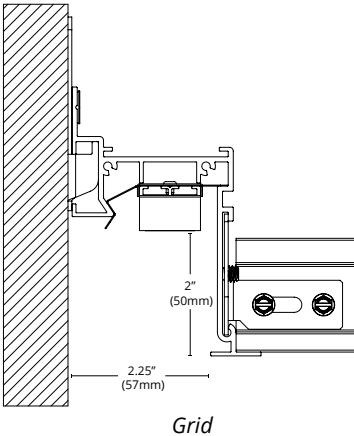

NOTES:

GIRO housings are provided as 4ft and 8ft lengths and are field cut to length and should be installed during construction of the ceiling like typical perimeter molding. GIRO light modules snap into place after construction of the housing and can be connected up to 12 linear feet per remote power supply (power supply sold separately, refer to website). Factory provided shop drawings will include run length information for housing and light modules, and bill of materials for components and accessories.

***Power supply ordered separately (refer to website).**

APPLICATIONS:

Executive, Medical, Health, Educational, Retail, Hotels, Airport, Hospitality and any other areas requiring recessed perimeter lighting.

MOUNTING:

A wall mounting bracket and twist clip is provided for every two feet of housing, and a joiner bracket is provided for every individual housing section. End caps are provided as a set for straight end configurations. Extra accessories can be ordered separately.

MATERIALS:

Housing: Powder coated aluminum extruded body, powder coated steel end caps, galvanized steel joiners, twist clips, and mounting brackets.

Light Module: Painted aluminum extruded body, stainless steel mounting clips, PC end caps, acrylic PMMA lens

ELECTRICAL/OPTICAL:

Light modules are 24VDC low voltage input and 8W per foot (power supply consumption not included). Light modules are available with 0-10 dimming to 1% or DALI with remote power supply (sold separately). Plenum rated input cables on each light module provided with quick connector to allow multiple modules to be easily connected together (max 12 feet of light module per power supply). Use solid copper wire or wire ferrules to fit into quick connectors. For FM Battery/Driver Kit, order separately.

WARRANTY:

5 years

LISTINGS:

ETL/cETLus CE RoHS. Indoor use only.
 IC Rated. IP 40. IP65 rated option
 IP ratings are intended below finished ceiling

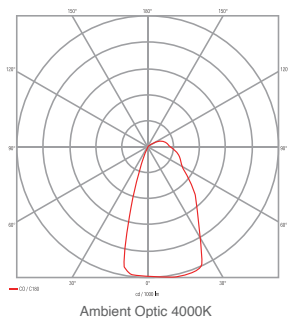

Photometrics CRI = >82

 $L_{80} > 60K$ hrs

Wall
35 FC average
2.8 average/min

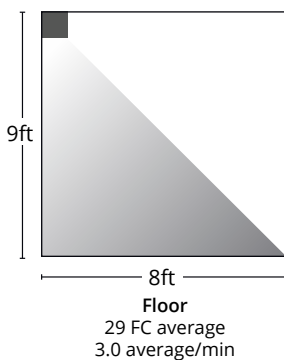

AM = Ambient

Output (lm/ft)	Power (watts/ft)	Efficacy (lm/W)
744	7.5	99

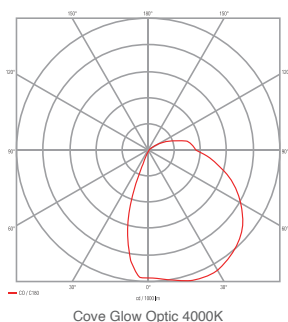

Wall
24 FC average
6.2 average/min

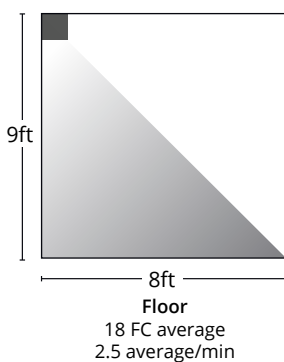

CG = Cove Glow

Output (lm/ft)	Power (watts/ft)	Efficacy (lm/W)
544	7.5	73

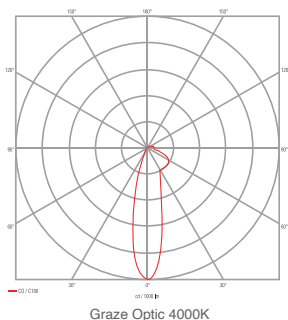

Wall
23 FC average
3.7 average/min

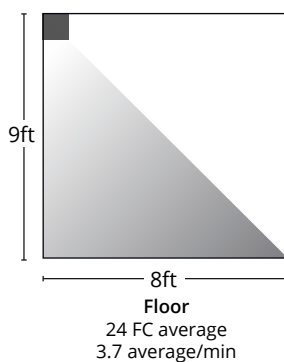

GZ = Graze

Output (lm/ft)	Power (watts/ft)	Efficacy (lm/W)
562	7.5	75

**Complete photometric info and IES files are available for download at www.jlc-tech.com*

Dimensions for Housing

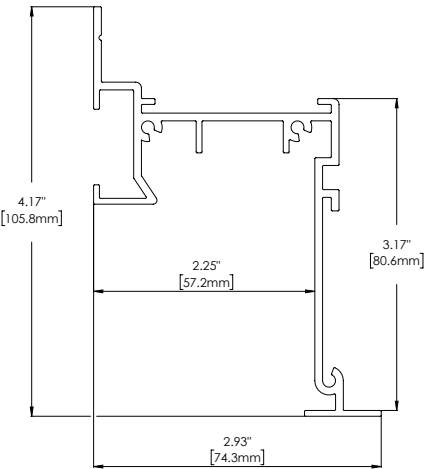

Grid/Flange Trim

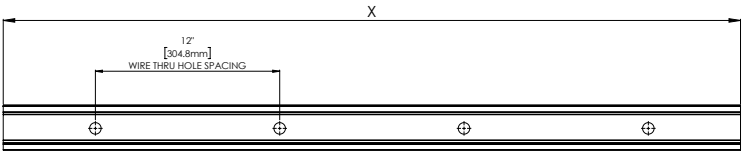

Length	X
4ft	48"
8ft	96"

Dimensions for Light Module

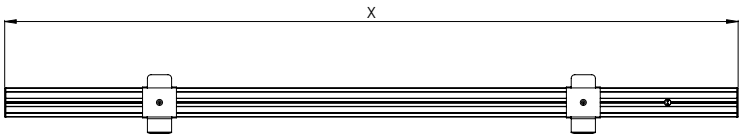
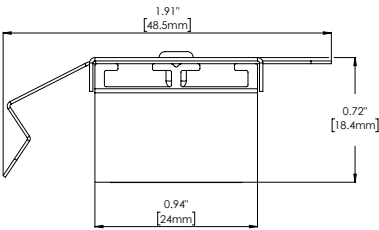

Length*	X
2ft	22.9"
4ft	46.9"

* Nominal 2ft and 4ft length dimensions shown for reference, other lengths will be provided as required (reference factory shop drawings).

Installation Details

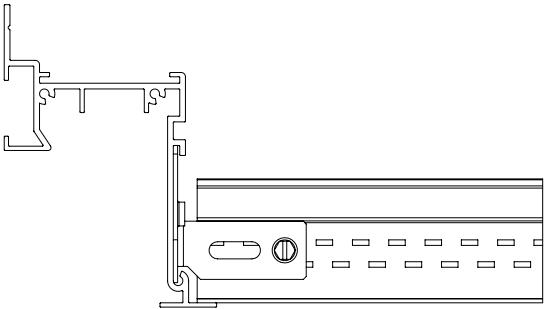

9/16" or 15/16" Flat Grid with Lay-in Tile

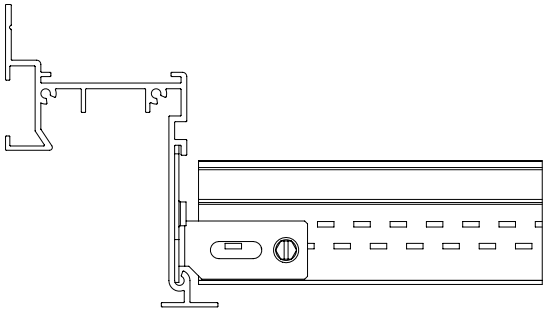

9/16" or 15/16" Flat Grid with Tegular Tile

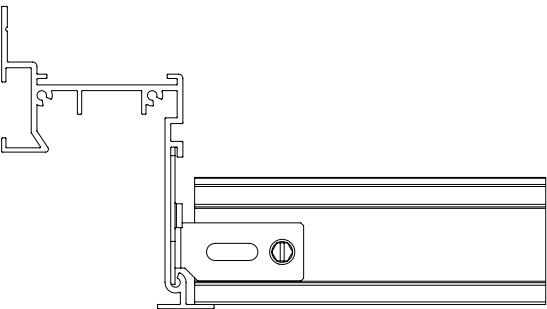

9/16" Dimensional Grid
(Bolt Slot or Bull Nose)

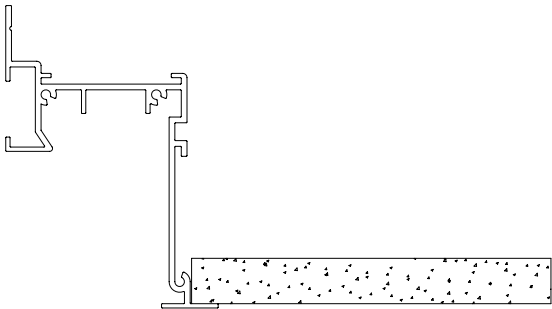

Gypsum Ceiling

Accessories

GIRO housings are provided with a few simple brackets for seamless integration into ceiling systems. Housings are provided with a wall mounting bracket and twist clip for every 2 feet of run length. One joiner will be provided per housing length. End caps will be included as required for each run length. Factory provided shop drawings will include the recommended bill of materials for each run length and the included brackets. Additional brackets can be ordered per the part numbers below. Optional QuietCorner™ accessory, (sold separately) for even wall illumination through inside corners.

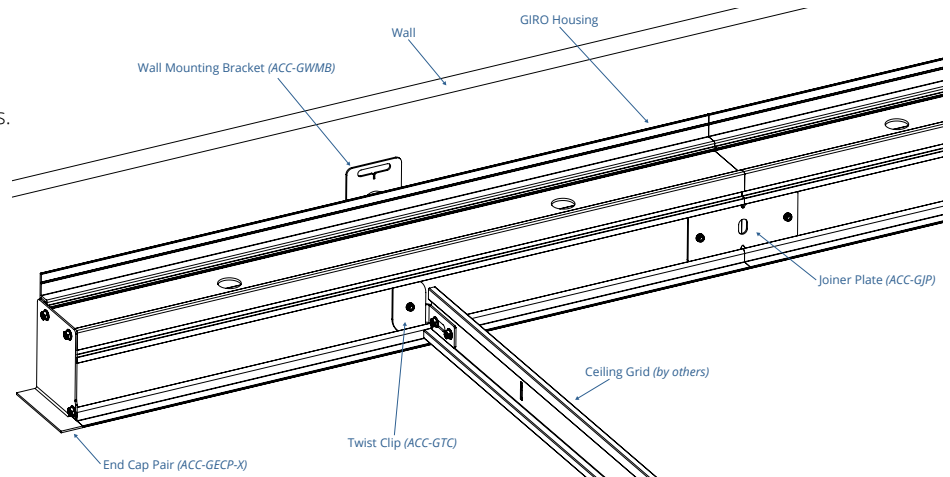

Extra Accessories (Optional)

To order extra accessories:

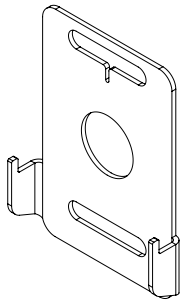

ACC-GWMB – Wall Mounting Bracket

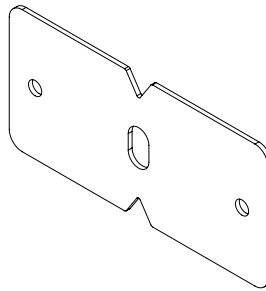

ACC-GJP – Joiner Plate
(Joiner plates are field bent as required for housing corners.)

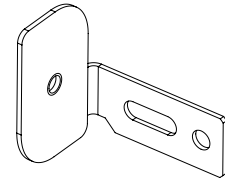

ACC-GTC – Giro Twist Clip

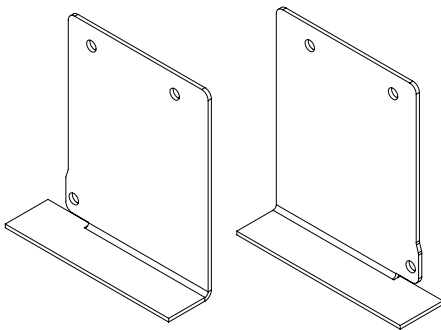

ACC-GECP-X – End Cap Pair – Grid/Flange

Specify End Cap Color "X":

W = White

B = Black

C = Custom

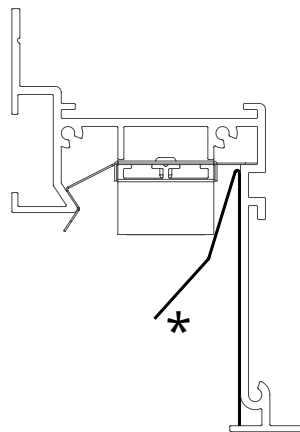

ACC-GQCO – QuietCorner Optic Accessory

QuietCorner™

* Optical accessory recommended for all inside corner configurations using ambient or cove glow optic, ([refer to website for more info](#)). Two QuietCorner optics required for each internal corner.

To order extra housing: **GIH-8FT0IN-X-X** for 8ft Housing

GIH-4FT0IN-X-X for 4ft Housing

Select mounting type and color as required.

How to Specify End Configuration

GIRO housings are field cut to length, including angles for corners. End configurations are only specified to determine the appropriate length of light modules provided, as well as ensuring proper accessories (i.e. joiners and end caps) are included. For GIRO runs continuing onto corners, each side of the wall is specified separately.

Straight End (S)

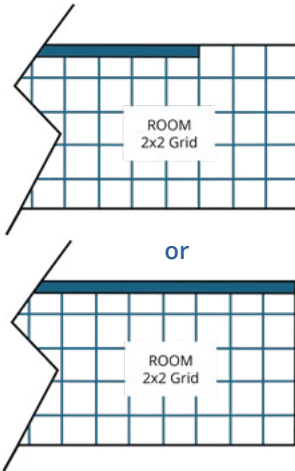

Internal Corner (I)

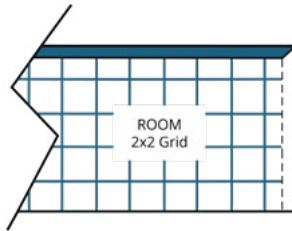

External Corner (E)

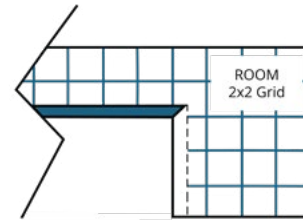

SS = When a linear run terminates on both ends without continuing onto another run.

SI = When a linear run continues onto another run on an inside corner on one end, and the other end stops.

SE = When a linear run continues onto another run on an external corner on one end, and the other end stops.

II = When a linear run continues onto two other runs through an inside corner on each end.

EE = When a linear run continues onto two other runs through an external corner on each end.

IE = When a linear run continues onto two other runs through an inside corner on one end and external corner on the other end.

Layout Examples

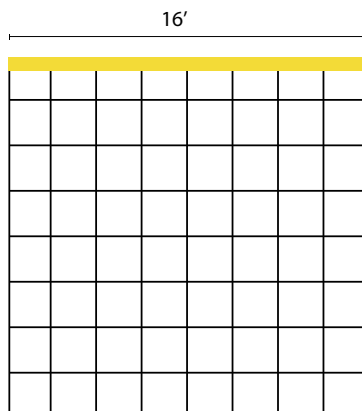

Specification Code:

(1) GIL-MW-16FT0IN-AM-SS + GIH-16FT0IN-G-W

Recommended Bill of Materials:

- (2) 8ft Housing
- (8) Wall Mounting Brackets
- (8) Twist Clips
- (2) Joiners
- (1) Set of End Caps
- (4) 4ft Light Modules

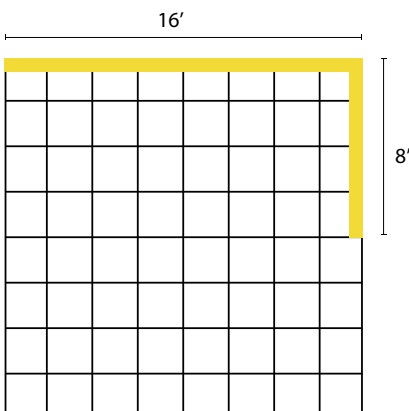

Specification Code:

(1) GIL-MW-16FT0IN-AM-SI + GIH-16FT0IN-G-W
(1) GIL-MW-8FT0IN-AM-SI + GIH-8FT0IN-G-W

Recommended Bill of Materials:

- (3) 8ft Housing
- (12) Wall Mounting Brackets
- (12) Twist Clips
- (3) Joiners
- (1) Set of End Caps
- (6) 4ft Light Modules
- (2) QuietCorner Optics

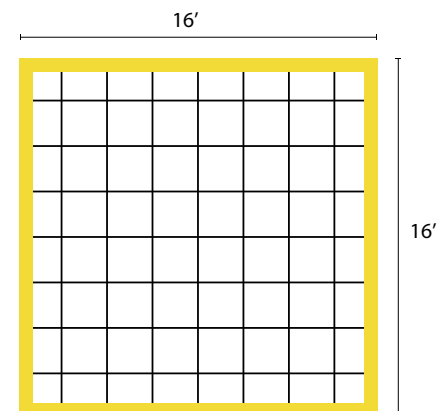

Specification code:

(4) GIL-MW-16FT0IN-AM-II + GIH-16FT0IN-G-W

Recommended Bill of Materials:

- (8) 8ft Housings
- (32) Wall Mounting Brackets
- (32) Twist Clips
- (8) Joiners
- (16) 4ft Light Modules
- (8) QuietCorner Optics