

T-BAR TWO | Order Specification Guide

T-BAR TWO®

Product Name	LED/K Color	Grid Size	Grid Type	Optic	Mounting Clips	Color	Options
TBTW = T-BAR TWO	HW = 3000K MW = 3500K MN = 4000K	2 = 2 ft 4 = 4 ft 4L Metric 6 = 60 cm 12 = 120 cm 12L	24 = 15/16" 15H = 9/16" High Efficiency ¹ 15HB = 9/16" High Efficiency Bolt Slot ¹ 24C = 15/16" Partially Concealed Grid ¹	CD = Cut-Off Reflector & Diffusing Lens CDWH = White Cut-Off Reflector & Diffusing Lens CDBL = Black Cut-Off Reflector & Diffusing Lens	U = Universal A = Armstrong C = Custom	W = White B = Black C = Custom	CP = Chicago Plenum Optional EM Battery/Driver Kit available (sold separately).

www.jlc-tech.com/patents

Power supply ordered separately.

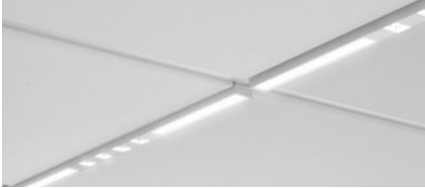
¹ Cannot be used for geometric shapes*Cut-Off Reflector & Diffusing Lens (CD)***NOTES:**

T-BAR TWO modules can be parallel connected up to 16 linear feet of each circuit max per power supply. Remote power supply includes JB compartment for AC input direct wiring with metal conduit. Max distance from power supply to fixtures is 30 feet with 18 AWG wire. Longer distance achievable if using higher gauge wire. Requires 200W Power Supply Kit.

[*Power supply ordered separately \(refer to website\).](#)

APPLICATIONS:

Executive, Medical, Health, Educational, Retail, Hotels, Airport, Hospitality and any open space areas that require a unique and elegant architectural lighting design.

MOUNTING:

Universal mounting brackets are for easy installation to standard 15/16" or 9/16" T-Bars of most manufacturers' ceiling suspension systems. Armstrong compatible mounting clips for installation with Armstrong Ceiling 15/16" Prelude® and Clean Room™, 9/16" Suprafine®, Silhouette®, Sonata® and Interlude® suspension systems. Compatible with Tegular and Lay-in tiles.

MATERIALS:

Anodized and painted aluminum extruded body, steel mounting clips, white PC end caps, high transmitting acrylic PMMA lens (diffusing lens) and high reflectance 98% aluminum coated or white or black PC reflectors for a dark light effect (cut-off reflector).

ELECTRIC:

Two circuit fixture consumes 10.8W on Circuit A Diffusion Lens (2ft fixture) and 5.75W on Circuit B Cut-Off Reflector (2ft fixture) or 21.6W on Circuit A (4ft fixture) and 11.3W on Circuit B (4ft fixture). Power supply consumption not included. Input voltage 24VDC. Fixtures are available with 0-10 dimming to 1% or DALI with remote power supply (sold separately). Junction box mounted on fixture with 4 cables of 20AWG inside for Circuit A and Circuit B connection to power supply.

[For EM Battery/Driver Kit, order separately.](#)

WARRANTY:

5 years

LISTINGS:

ETL/cETLus CE RoHS. Indoor use only. IC Rated. IP 20.

IP ratings are intended below finished ceiling

Photometrics

CRI = >82

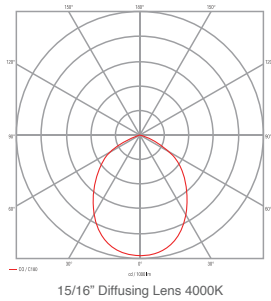
 $L_{80} > 60K$ hrs**Diffusing Lens – Grid Type: 24 and 15H/15HB**

TBSL-MN-X-24-D-X-X
 400 lm per foot
 75 lm/W

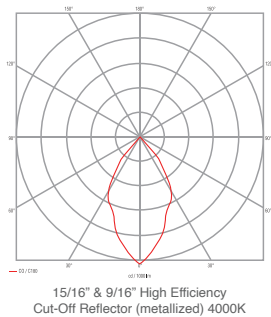
**Cut-Off Reflector – Grid Type: 24 and 15H/15HB (metallized finish)**

TBSL-MN-X-24-C2-X-X
 169 lm per foot
 60 lm/W

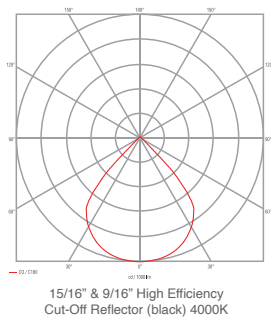
**Cut-Off Reflector – Grid Type: 24 and 15H/15HB (black finish)**

TBSL-MN-X-15-B-X-X
 105 lm per foot
 37 lm/W

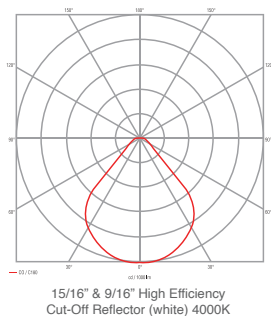
**Cut-Off Reflector – Grid Type: 24 and 15H/15HB (white finish)**

TBSL-MN-X-15-B2-X-X
 164 lm per foot
 58 lm/W

Profile Dimensions
(Compatible with Tegular and Lay-in tiles)

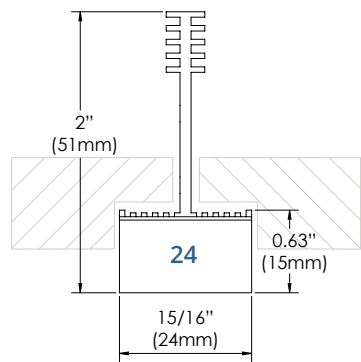

15/16" Cut-Off Reflector & Diffusing Lens
TBTW-XX-X-24-CD-X-X-X

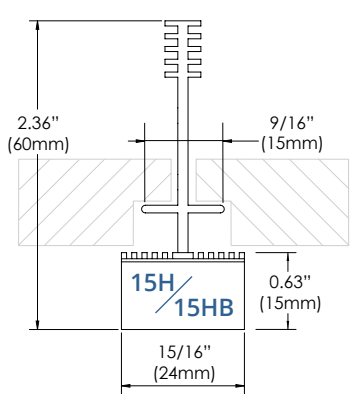

9/16" High Efficiency
Cut-Off Reflector & Diffusing Lens
TBTW-XX-X-15H/15HB-CD-X-X-X

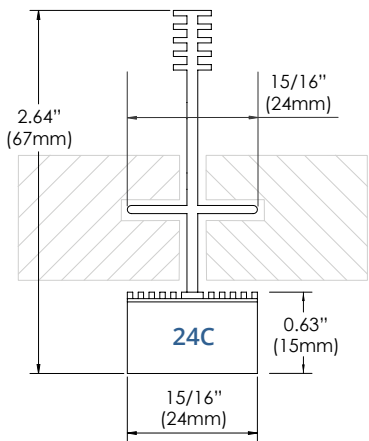

15/16" Concealed Cut-Off Reflector
& Diffusing Lens
TBTW-XX-X-24C-CD-X-X-X

Length Dimensions

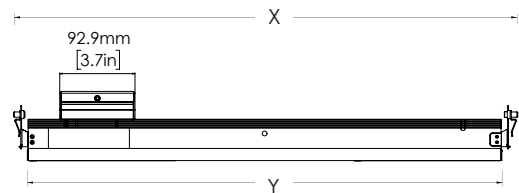
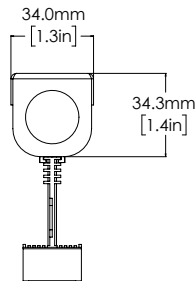

Size	Grid Type	X	Y
2 = 2ft	24 = 15/16"	24"	23"
4 = 4ft	24 = 15/16"	48"	47"
4L	24 = 15/16"	48"	24"

Size	Grid Type	X	Y
2 = 2ft	15H/15HB = 9/16"	24"	23.4"
4 = 4ft	15H/15HB = 9/16"	48"	47.4"

Size	Grid Type	X	Y
2 = 2ft	24C = 15/16"	24"	23.7"
4 = 4ft	24C = 15/16"	48"	47.8"