

Sorella | Order Specification Guide

Sorella®

1. Specify Light Module

Product Name	LED/K Color	Length	Aperture	Optic	Color	Options
SOR = Sorella Light Module	HW = 3000K MW = 3500K MN = 4000K CN = 5000K For tunable white, consult factory.	1 = 1 ft 2 = 2 ft 3 = 3 ft 4 = 4 ft 5 = 5 ft	24 = 15/16" 15 = 9/16"	D = Diffusing Lens DW = Diffused White B = Block Clear Diffusing Lens B2 = Block Frosted Diffusing Lens C2 = Multi-Reflector C2WH = White Multi-Reflector C2BL = Black Multi-Reflector A2 = Asymmetric S = Signage	W = White B = Black C = Custom	IP = IP65 ¹ Optional EM Battery/Driver Kit available (sold separately).

2. Specify Housing

¹ Not available in C2 Model

Product Name	Length	Aperture	Mounting	Color	Options
SORH = Sorella Housing	1 = 1 ft 2 = 2 ft 3 = 3 ft 4 = 4 ft 5 = 5 ft	24 = 15/16" 15 = 9/16"	MF = Mud Flange FL = Flange Trim	W = White B = Black C = Custom Leave blank for Mud-Flange	CP = Chicago Plenum ²

www.jlc-tech.com/patents

Power supply ordered separately.

² Not available in 9/16"

Example specification code: **SOR-MW-1-15-B-W + SORH-1-15-MF**

Diffusing Lens (D)



Diffused White Lens (DW)

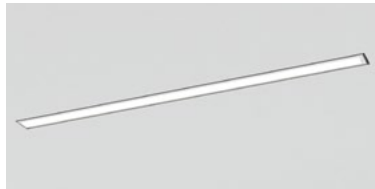

Block Clear Diffusing Lens (B)



Block Frosted Diffusing Lens (B2)



Multi-Reflector (C2BL)



Asymmetric Lens (A2)



Signage (S)

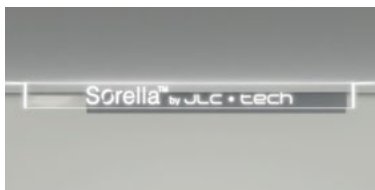

NOTES:

Sorella modules can be parallel connected up to 12 linear feet max per power supply. Remote power supply includes JB compartment for AC input direct wiring with metal conduit, must be installed in an accessible location. Max distance from power supply to fixtures is 30 feet with 18 AWG wire. Longer distance achievable if using higher gauge wire.

*Power supply ordered separately (refer to website).

APPLICATIONS:

Executive, Medical, Health, Educational, Retail, Hotels, Airport, Hospitality and any open space areas that require a unique and elegant architectural lighting design.

MOUNTING:

Mud flange housing for trimless installation into gypsum ceiling applications. Appropriate backer or fasteners required. Flange trim mounting with spring clips also available.

MATERIALS:

Light Module: Anodized and painted aluminum extruded body, stainless steel mounting clips, white PC end caps, high transmitting acrylic PMMA lens, (D, DW, B, B2 Models), high reflectance 98% aluminum coated or white or black PC reflectors on each LED for a dark light effect, (C2 Models). **Housing:** Aluminum extruded, flange trim option powdered coated.

ELECTRICAL/OPTICAL:

Fixtures consume 8W/ft. Power supply consumption not included. Input voltage 24VDC. Light modules are available with 0-10V or DALI dimming (dimable to 1%) with remote power supply (sold separately). Plenum rated input cable provided with quick connector to allow multiple modules to be easily connected together (max 12 linear feet of product). Use solid copper wire or wire ferrules to fit into quick connectors. [For EM Battery/Driver Kit, order separately.](#) For Chicago Plenum option, housing is provided with a gasketed and sealed junction box, refer to website for more info

WARRANTY:

5 years

LISTINGS:

ETL/cETLus CE RoHS. Indoor use only. IC Rated.
IP 40, IP 20 (C2 Models). IP65 rated option
IP ratings are intended below finished ceiling

Photometrics CRI = >82

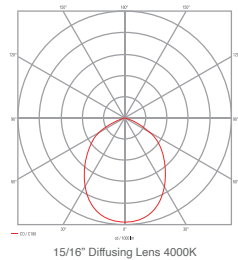
 $L_{80} > 60K$ hrs

D = Diffusing Lens

Aperture	Output (lm/ft)	Power (watts/ft)	Efficacy (lm/W)
24 = 15/16"	584	8	75
15 = 9/16"	445	8	54

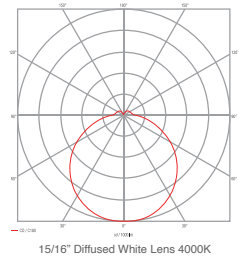

DW = Diffused White

Aperture	Output (lm/ft)	Power (watts/ft)	Efficacy (lm/W)
24 = 15/16"	532	8	73
15 = 9/16"	377	8	51

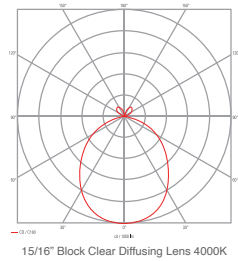

B = Block Clear Diffusing Lens

Aperture	Output (lm/ft)	Power (watts/ft)	Efficacy (lm/W)
24 = 15/16"	564	8	72
15 = 9/16"	438	8	56

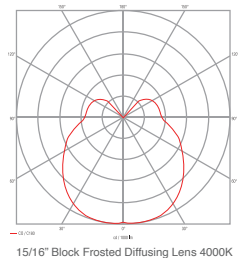

B2 = Block Frosted Diffusing Lens

Aperture	Output (lm/ft)	Power (watts/ft)	Efficacy (lm/W)
24 = 15/16"	586	8	75
15 = 9/16"	460	8	59

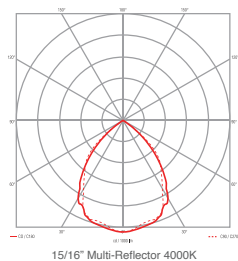

C2 = Multi-Reflector (Metalized finish)

Aperture	Output (lm/ft)	Power (watts/ft)	Efficacy (lm/W)
24 = 15/16"	784	8	100
15 = 9/16"	769	8	98

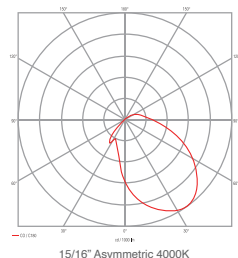
*C2WH and C2BL IES files available on www.jlc-tech.com

A2 = Asymmetric

Aperture	Output (lm/ft)	Power (watts/ft)	Efficacy (lm/W)
24 = 15/16"	582	8	75
15 = 9/16"	484	8	62

*Complete photometric info and IES files are available for download at www.jlc-tech.com

Profile Dimensions for Mud Flange

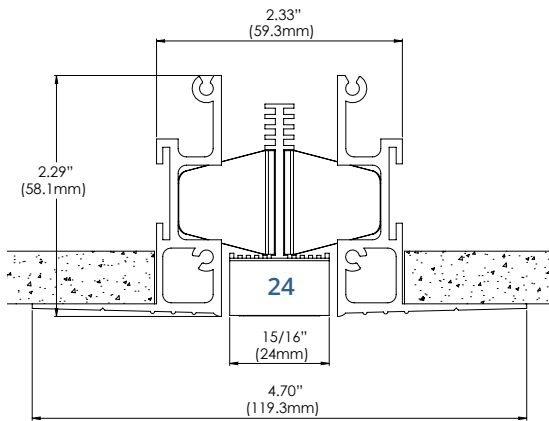

15/16" Diffusing Lens/Multi-Reflector
SOR-XX-X-24-D/C2-X + SORH-X-24-MF

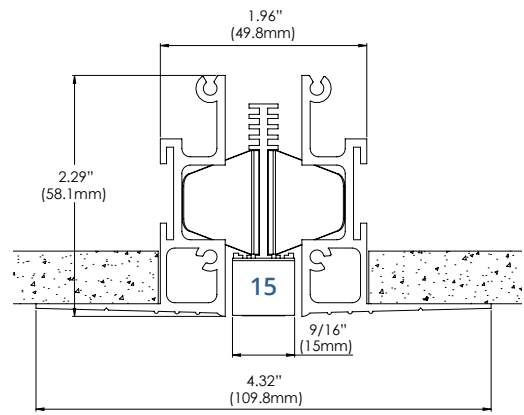

9/16" Diffusing Lens/Multi-Reflector
SOR-XX-X-15-D/C2-X + SORH-X-15-MF

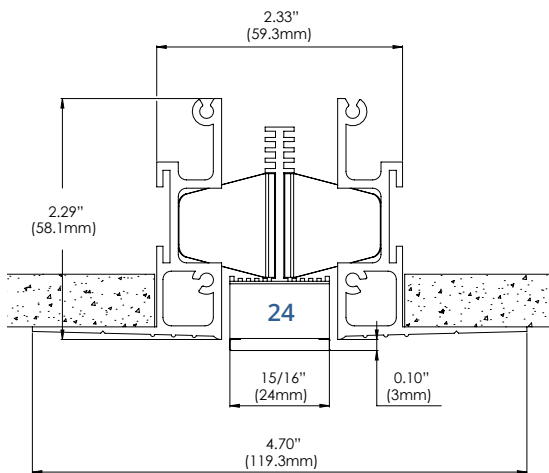

15/16" Diffused White Lens
SOR-XX-X-24-DW-X + SORH-X-24-MF

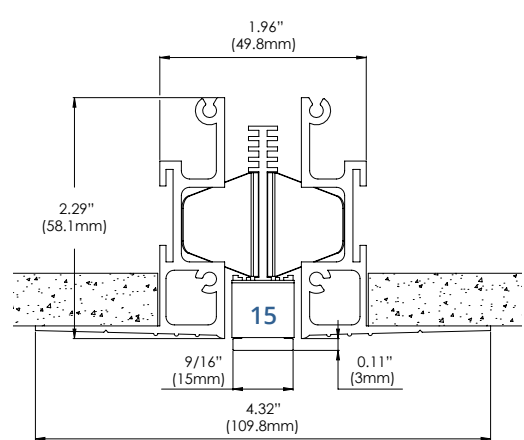

9/16" Diffused White Lens
SOR-XX-X-15-DW-X + SORH-X-15-MF

Clear block and frosted block variable heights 1/2" – 4" available, consult factory.

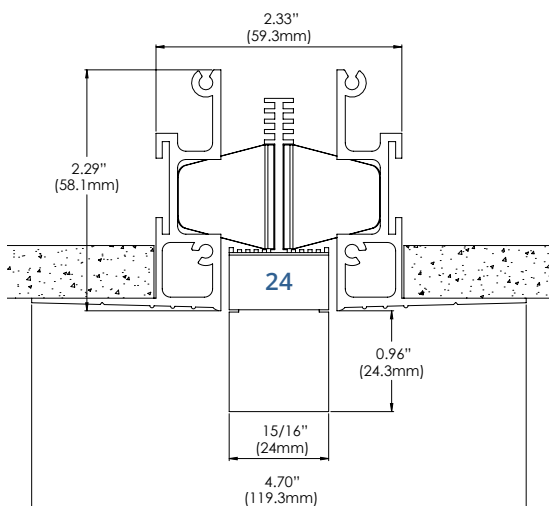

15/16" Block Lens
SOR-XX-X-24-B/B2-X + SORH-X-24-MF

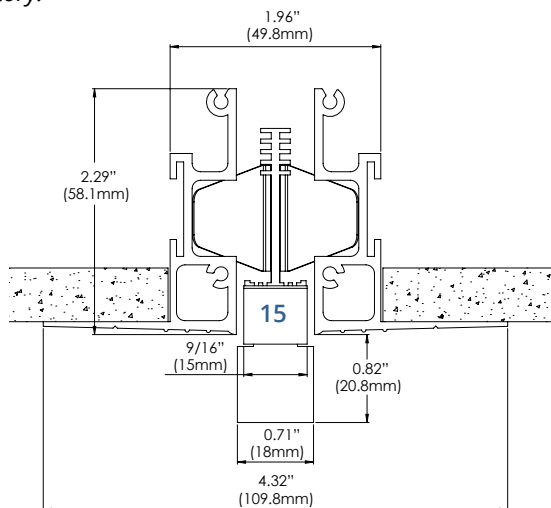

9/16" Block Lens
SOR-XX-X-15-B/B2-X + SORH-X-15-MF

Profile Dimensions for Mud Flange

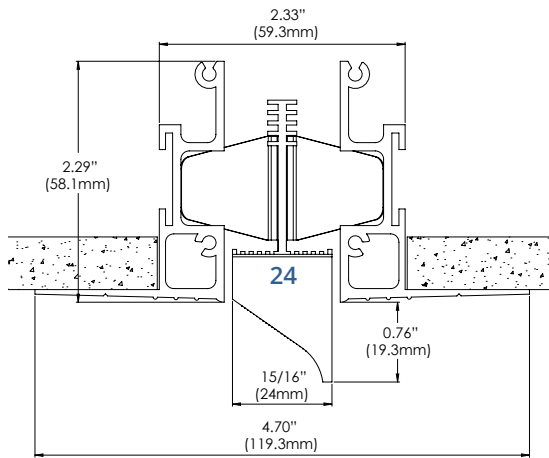

15/16" Asymmetric Lens
SOR-XX-X-24-A2-X + SORH-X-24-MF

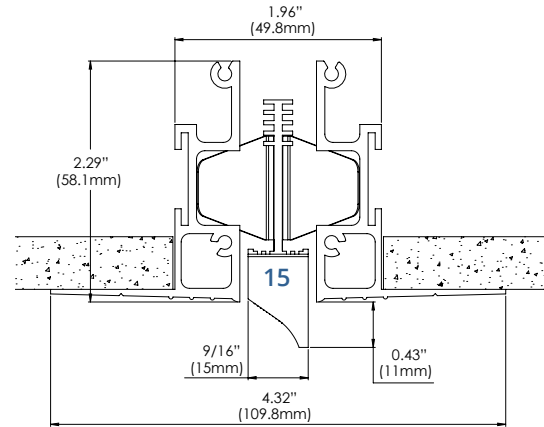

9/16" Asymmetric Lens
SOR-XX-X-15-A2-X + SORH-X-15-MF

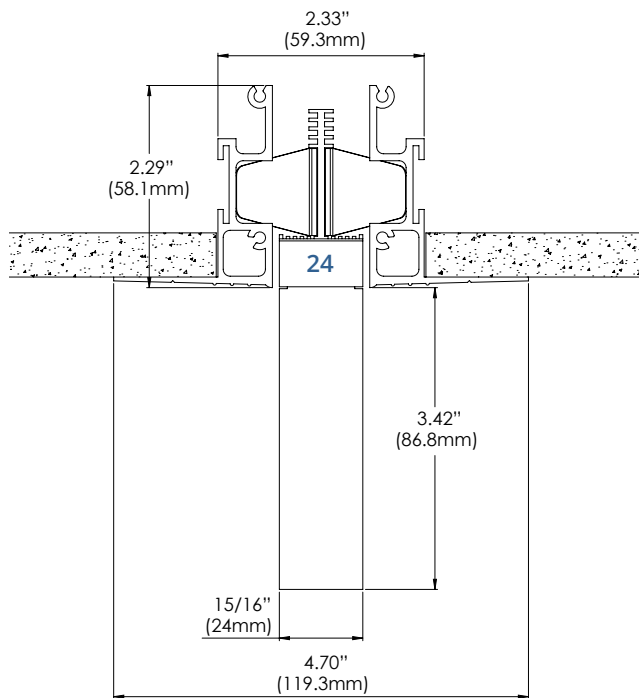

15/16" Signage
SOR-XX-X-24-S-X + SORH-X-24-MF

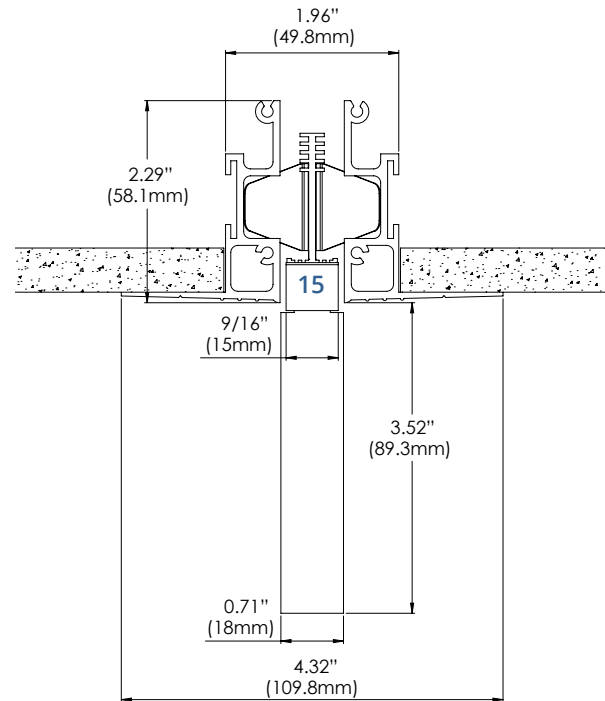

9/16" Signage
SOR-XX-X-15-S-X + SORH-X-15-MF

Length Dimensions for Mud Flange

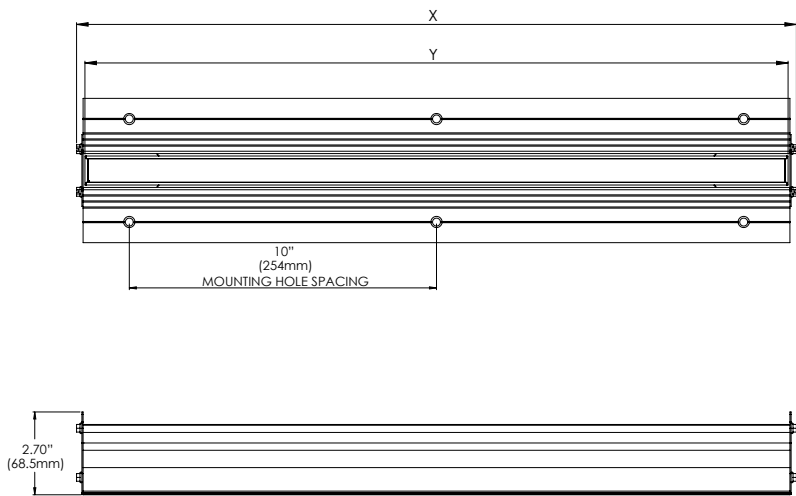

**For gypsum cut-out dimensions, refer to installation instruction.*

Length	Aperture	X	Y
1 = 1ft	15 = 9/16"	12.1"	11.6"
2 = 2ft	15 = 9/16"	23.4"	22.9"
3 = 3ft	15 = 9/16"	34.8"	34.2"
4 = 4ft	15 = 9/16"	46.8"	46.3"
5 = 5ft	15 = 9/16"	59.6"	59.1"

Length	Aperture	X	Y
1 = 1ft	24 = 15/16"	12.1"	11.6"
2 = 2ft	24 = 15/16"	23.4"	22.9"
3 = 3ft	24 = 15/16"	34.8"	34.2"
4 = 4ft	24 = 15/16"	46.8"	46.3"
5 = 5ft	24 = 15/16"	59.6"	59.1"

Profile Dimensions for Flange Trim

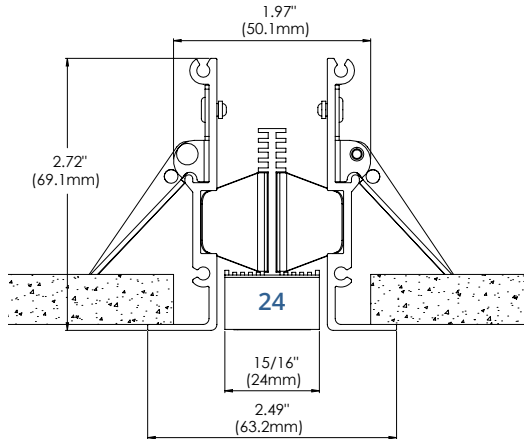

15/16" Diffusing Lens/Multi-Reflector
SOR-XX-X-24-D/C2-X + SORH-X-24-FL

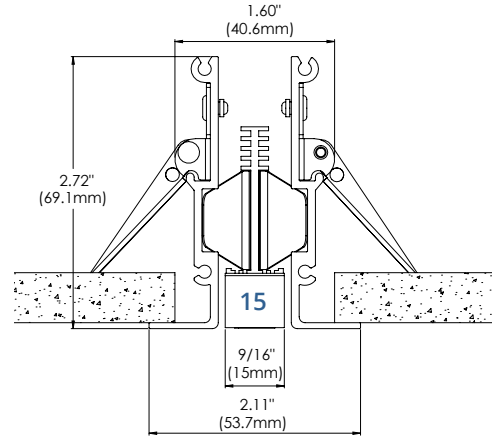

9/16" Diffusing Lens/Multi-Reflector
SOR-XX-X-15-D/C2-X + SORH-X-15-FL

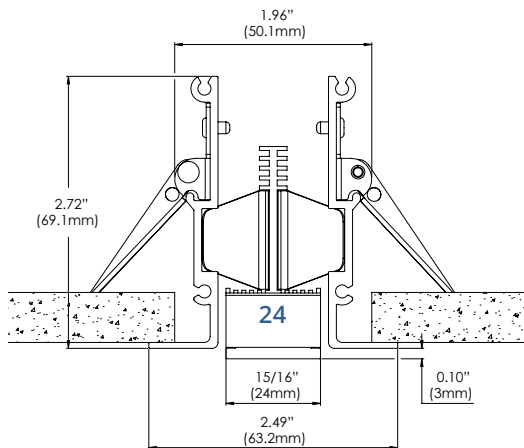

15/16" Diffused White Lens
SOR-XX-X-24-DW-X + SORH-X-24-FL

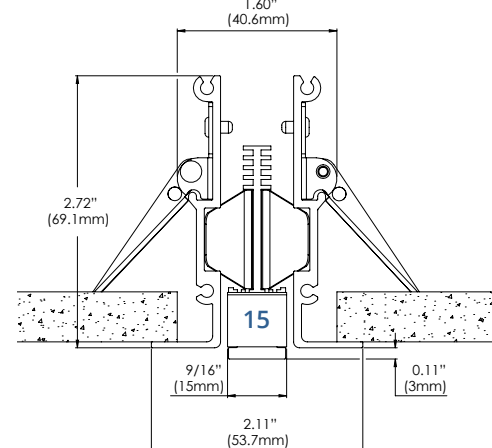

9/16" Diffused White Lens
SOR-XX-X-15-DW-X + SORH-X-15-FL

Clear block and frosted block variable heights 1/2" – 4" available, consult factory.

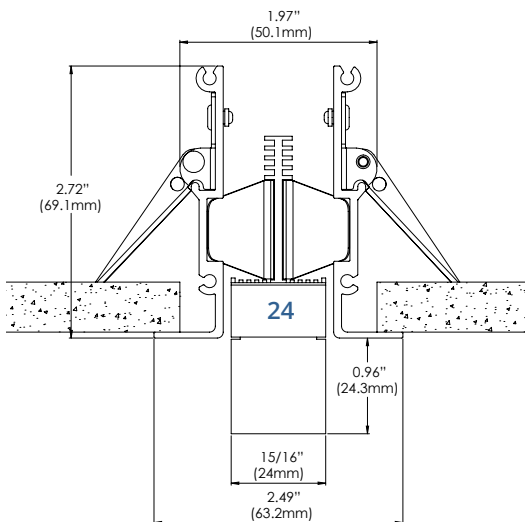

15/16" Block Lens
SOR-XX-X-24-B/B2-X + SORH-X-24-FL

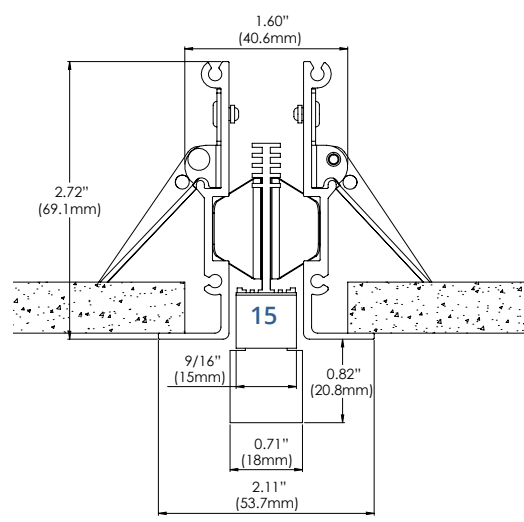

9/16" Block Lens
SOR-XX-X-15-B/B2-X + SORH-X-15-FL

Profile Dimensions for Flange Trim

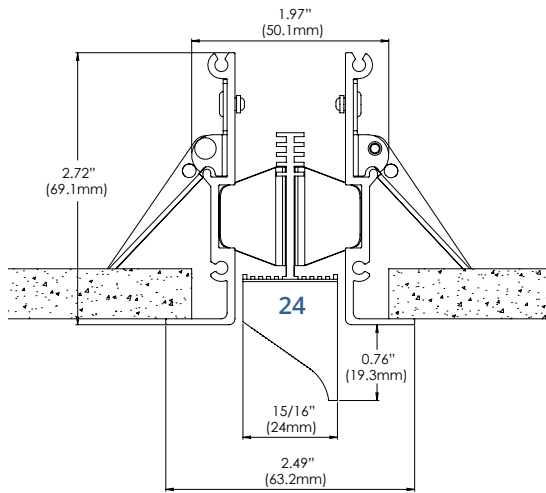

15/16" Asymmetric Lens
SOR-XX-X-24-A2-X + SORH-X-24-FL

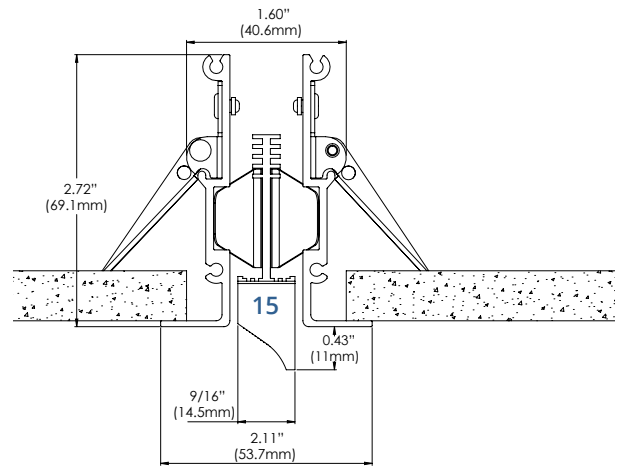

9/16" Asymmetric Lens
SOR-XX-X-15-A2-X + SORH-X-15-FL

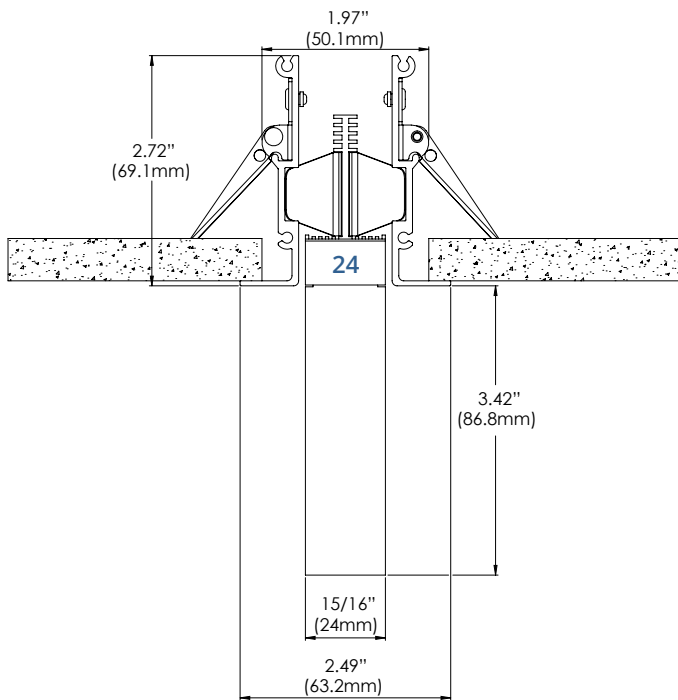

15/16" Signage
SOR-XX-X-24-S-X + SORH-X-24-FL

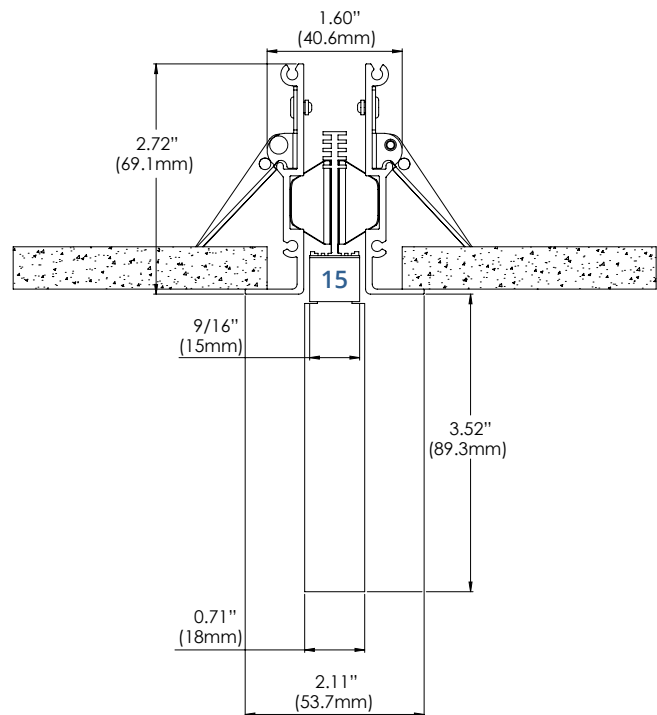

9/16" Signage
SOR-XX-X-15-S-X + SORH-X-15-FL

Length Dimensions for Flange Trim

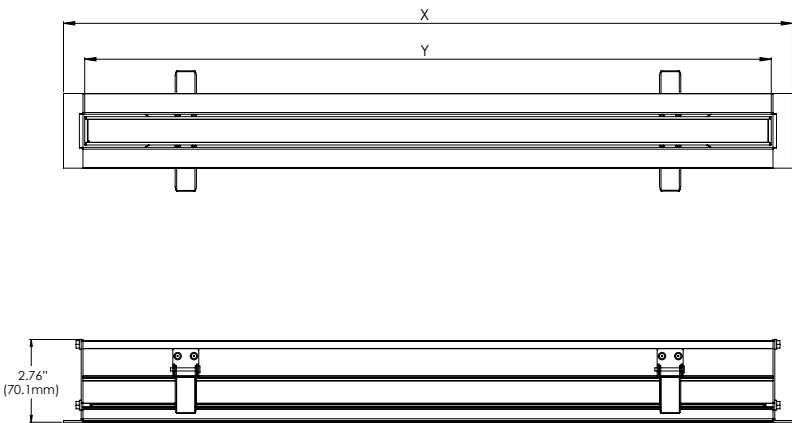

**For gypsum cut-out dimensions, refer to installation instruction.*

Length	Aperture	X	Y
1 = 1ft	15 = 9/16"	13.0"	11.6"
2 = 2ft	15 = 9/16"	24.3"	22.9"
3 = 3ft	15 = 9/16"	35.6"	34.2"
4 = 4ft	15 = 9/16"	47.7"	46.3"
5 = 5ft	15 = 9/16"	60.5"	59.1"

Length	Aperture	X	Y
1 = 1ft	24 = 15/16"	13"	11.6"
2 = 2ft	24 = 15/16"	24.3"	22.9"
3 = 3ft	24 = 15/16"	35.6"	34.2"
4 = 4ft	24 = 15/16"	47.7"	46.3"
5 = 5ft	24 = 15/16"	60.5"	59.1"